

polspotten.nl
global-from-holland

Bufferlamp

designed by **studio wieki somers**
230-450-series

“ Thank you for choosing a pols potten product.
To ensure safe and satisfactory use of this product,
please carefully read the below instructions beforehand.”

general information

⚠ important!

Always turn off power to the main electrical circuit before starting installation work. In certain countries electrical installations may only be carried out by an authorised or certified electrician. When in doubt seek advice from a professional electrician.

- The shade of the lamp is made of porcelain with a gold finish on the inside and CE certified electrical parts. Including a white porcelain ceiling cap. Hanging hook is not included since different ceiling materials require different types of hanging devices. We suggest the use of an open eye screw. For advice on suitable hanging devices, contact your local hardware store specialist. The maximum load weight depends on the hook that is used. The weight of the lamp itself is 3,5kg.
- Light bulb E27, MAX40W. Recommended light source: 4W LED.
- This lamp is for indoor ceiling use only.

safety instructions

- Connect to 220-240V AC only.
- Always use the correct type of light bulb and wattage, never exceed the wattage stated above.
- When changing a light bulb, always switch off at the main switch and allow the old bulb to cool down before handling. Carefully dispose of used light bulbs.
- Installation of the lamp shall be done by a qualified person.
- Verify that the electrical box that houses the wiring connections in the ceiling can support the weight of the lamp.
- Make sure there are no other wires running through the place where the hanging hook will be placed.
- The hanging hook should have the appropriate size and screw length in order to support the weight of the lamp.
- If the external cable of this luminaire is damaged, it shall be exclusively replaced by any qualified person.
- This lamp should not be adapted or modified in any way.
- Please keep these instructions for future reference.

care instructions

- We recommend cleaning the interior and exterior of the lamp with a soft, dry cloth. Avoid contact with abrasive, alcohol and solvent based substances or cleaning agents, they can damage the surface.
- Do not strike with hard or sharp items.

hanging instructions

step 1

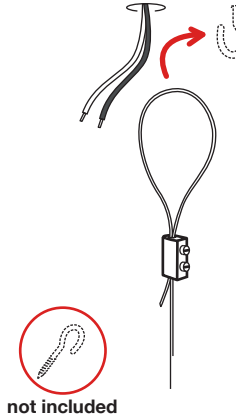

step 2

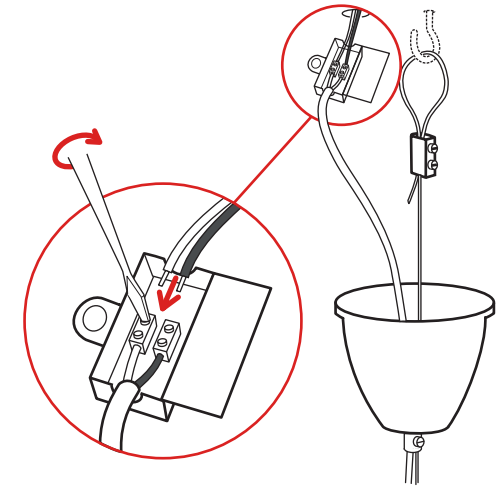

step 3

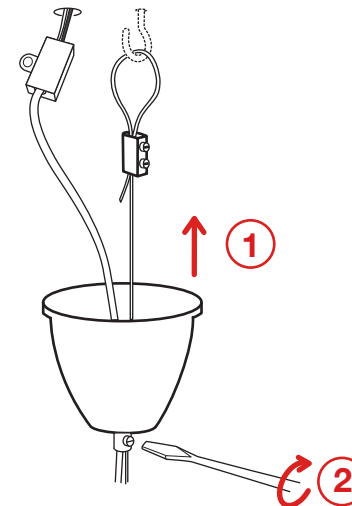

step 4

